

STAIR 1 SECTION - LOWER

1 : 50

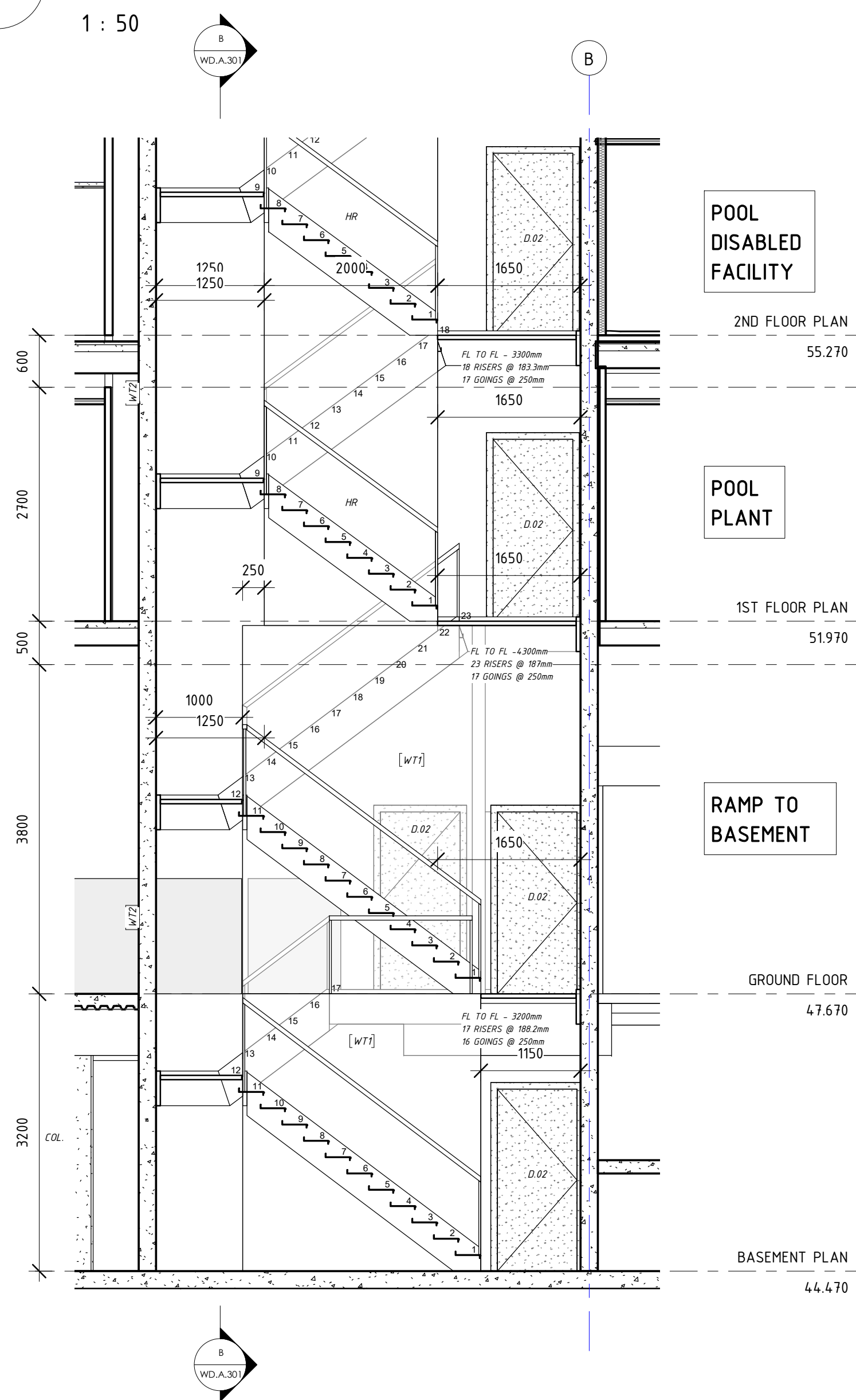

STAIR 1 SECTION - UPPER

1 : 50

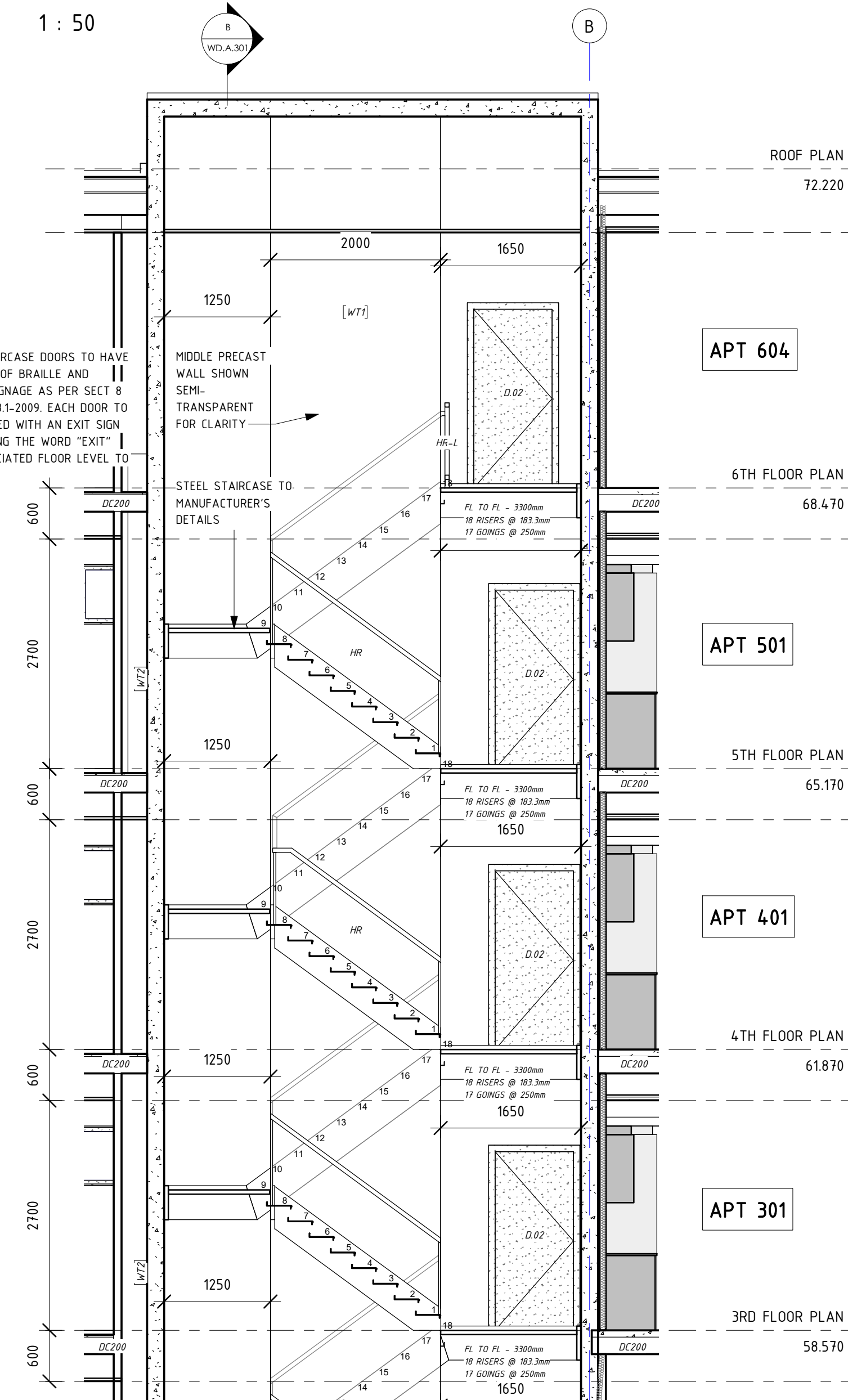

TUBE STEEL HANDRAIL FIXED TO CENTRAL PRECAST WALL AT A HEIGHT OF NOT LESS THAN 865mm MEASURED ABOVE THE NOSINGS OF STAIR TREADS AND THE FLOOR SURFACE OF THE RAMP, LANDING, OR THE LIKE

NOTE: NOSING TO THE TREADS TO HAVE NOT LESS THAN 50MM AND NOT GREATER THAN 75 MM DEEP ACROSS THE FULL WIDTH OF THE TREAD AND WITH A DIFFERENCE IN THE LEVEL OF NOT MORE THAN 5MM IN COLOUR WITH 30% CONTRAST TO THE BACKGROUND

STAIR DETAIL

1 : 20

HANDRAIL DETAIL

1 : 5

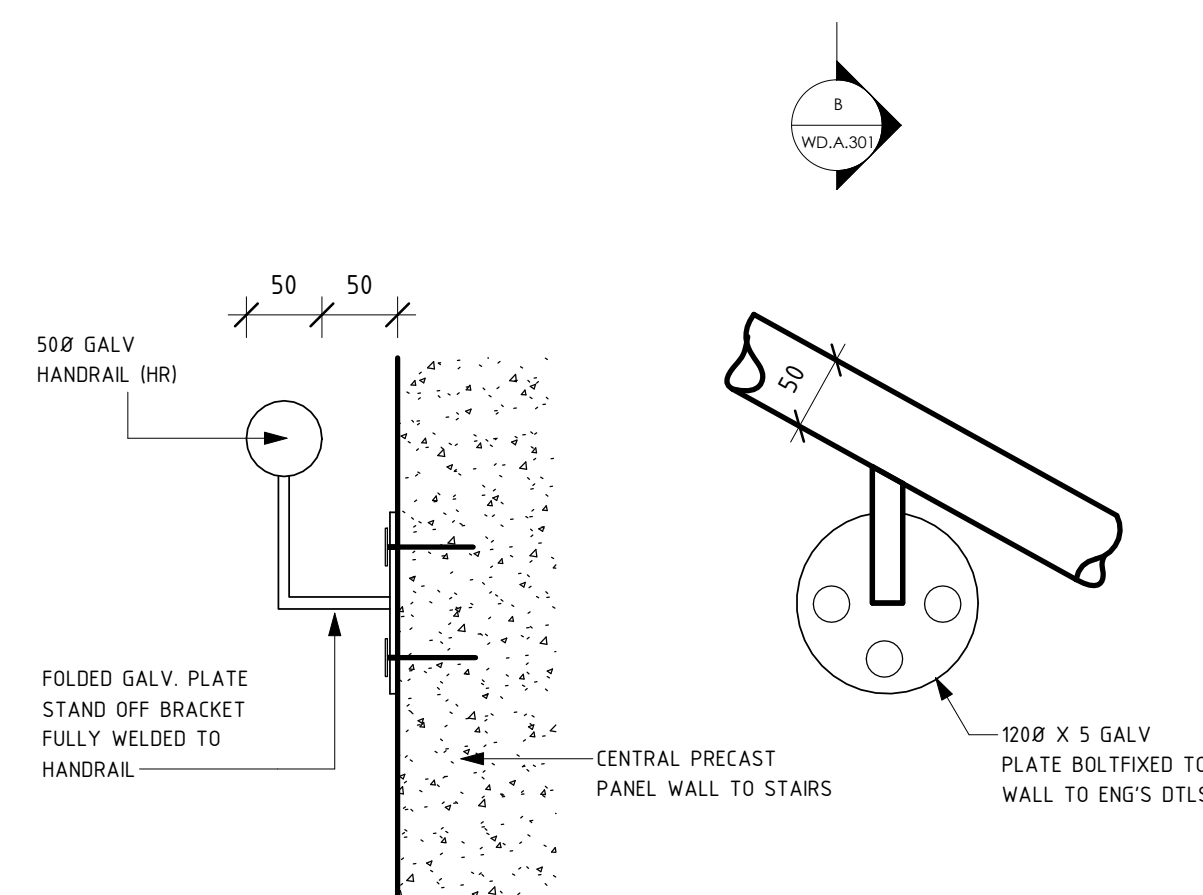

REVISONS		
ISSUE #	DATE	DESCRIPTION
A	25/03/2019	FOR BRC APPROVAL
B	14/05/2019	REVISED SET BASED ON BRC RFI PC59515

PROJECT ADDRESS
248 UNLEY ROAD HYDE PARK
HYDE PARK PLACE - STAGE A

CLIENT
HYDE PARK PLACE PTY LTD

CITIFY



SHEET
DETAILS 04

WD.A.403

AUTHOR
GB

CURRENT REVISION
REVISED SET BASED ON
BRC RFI PC59515

ISSUE DATE
29/06/2019

FOR TENDER

GEMMA

www.gemmalea.com.au
gemma@gemmalea.com.au
ABN: 39 882 991 838

LEA
DESIGN STUDIO